

Proposed Amendment to TPO plan to  
eliminate A1 and alter A2,

Tree Preservation Order 646(2018)



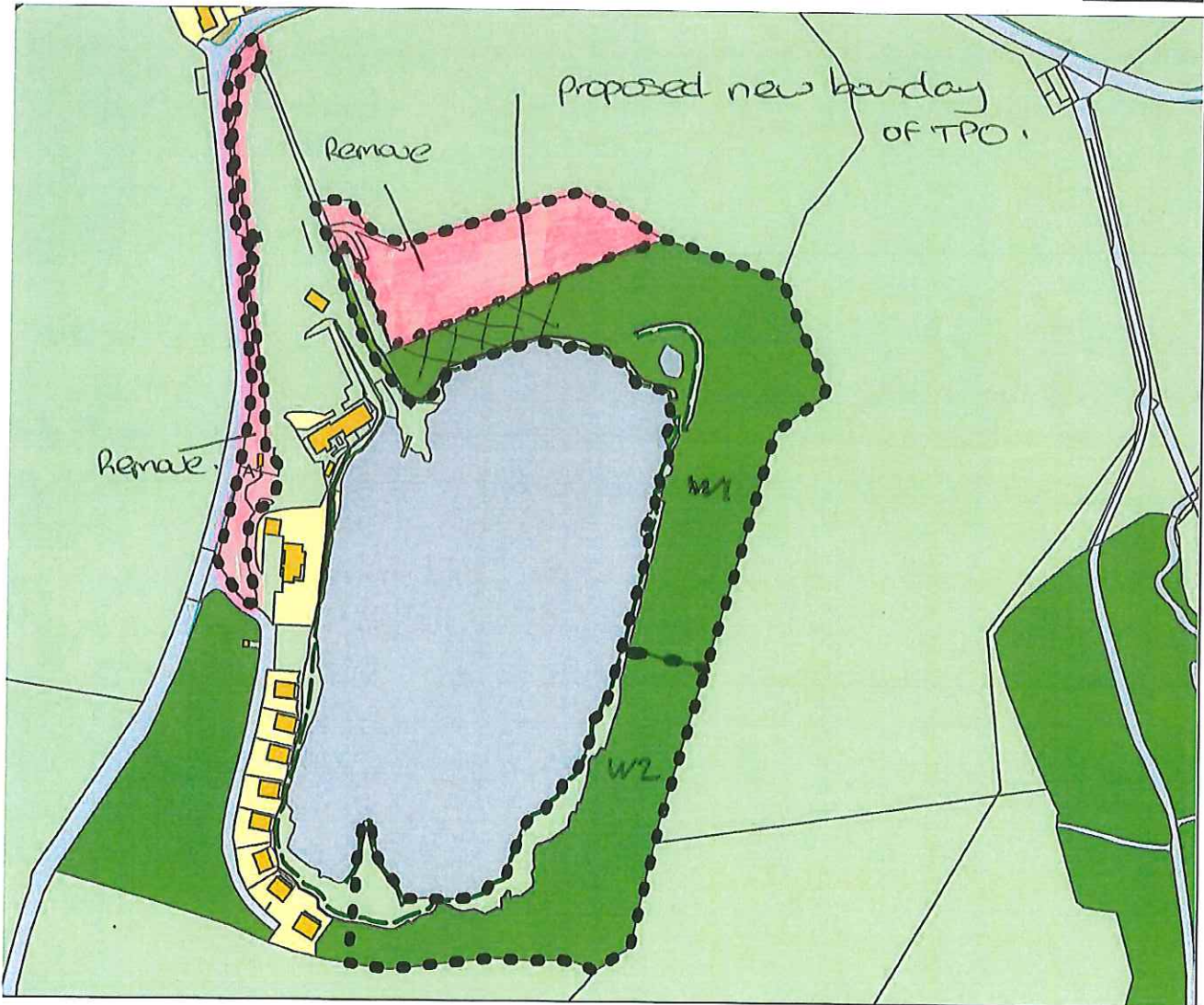

GIS by ESRI (UK)

Capernwray Diving Centre Jackdaw Quarry Capernwray



**Legend**

Mark Cassidy  
p.p. Chief Officer (REGENERATION AND PLANNING)

 - approximate location of felled trees  
 - Proposed removal of these areas from TPO

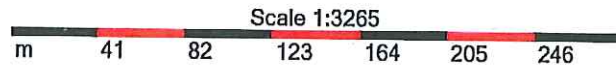

Reproduced from the Ordnance Survey map with the permission of the Controller of Her Majesty's Stationery Office © Crown Copyright 2000.

Unauthorised reproduction infringes Crown Copyright and may lead to prosecution or civil proceedings.

Organisation	Not Set
Department	Not Set
Comments	Not Set
Date	02 May 2018
SLA Number	Not Set